



A Five-Star Prize

THIS STUNNING NEW HAMPSHIRE LOG HOME EARNED ENERGY STAR'S HIGHEST RATING FOR OPTIMAL ENERGY SAVINGS.

BY DEBRA GRAHL ▲ PHOTOGRAPHY BY ROGER WADE STUDIO

"IT ALL STARTED WAY BACK," begins Brad Thompson, telling the story of how he and his wife, Daryl, came to acquire their 362-acre farm in the rural community of Stewartstown, in northern New Hampshire. "I grew up in the town of Winchester, on an 1,100-acre farm. In 1974, my dad, brother, and I built a hunting and fishing camp in Clarksville, just north of here. I guess I have the love of the land bred into me." His father, at 88 years of age, is still enjoying the camp, his very own piece of paradise.

Brad and Daryl's primary residence is in Gilford, New Hampshire, near Lake Winnepesaukee. To say the couple's life there is busy is an understatement. Brad owns an architectural precast manufacturing business and is very involved in the day-to-day operations. Daryl is immersed in community activities with friends and family. She has also recently co-authored a cookbook, compiling recipes from fellow island residents on Lake Winnepesaukee, entitled *Hungry for Summer*.



THE THOMPSONS SITUATED THEIR HOME ON A HILLSIDE THAT SLOPES DOWN TO A LARGE FRUIT FLOWER, AND VEGETABLE GARDEN. THE HILLSIDE ALLOWED THE COUPLE TO PLACE THEIR GARAGE BENEATH THE MAIN LEVEL OF THE HOUSE.

OPPOSITE: THE FRONT PORCH IS LADEN WITH PLANTINGS IN HUGE POTS AND VESSELS. THE VIEWS OF THE FARM FIELDS AND SURROUNDING MOUNTAINS MAKE FOR A WONDERFUL ENTERTAINMENT AREA. THE HAND-CARVED BEAR AT THE TOP OF THE STAIRS TO THE PORCH WAS CREATED BY TERRY MCKENNDREE, OF BUCK RIDGE CHAINSAW CARVING, DEKALB JUNCTION, NEW YORK.



GREEN TIP

BRAD THOMPSON SAYS, "WE SELECTED PROPANE FUEL AND A HOT-WATER RADIANT HEATING SYSTEM TO HEAT OUR HOME AND WERE VERY HAPPY WITH THE FIRST YEAR'S HEATING COSTS, ESPECIALLY CONSIDERING THAT WE WERE STILL PARTIALLY UNDER CONSTRUCTION UNTIL EARLY FEBRUARY. I BELIEVE THAT AN IMPORTANT FACTOR FOR THE VERY ACCEPTABLE FUEL COSTS IS THE CONSISTENT SIX-INCH LOG MASS OF OUR HOME."

In recent years, Brad found himself spending more time at the hunting camp up north. He began to contemplate a more comfortable, year-round getaway that would also accommodate family and friends. When he came upon an opportunity to purchase 362 acres of pasture, fields, and timberland near the old camp he couldn't resist.

Deciding what type of home to build on their new property posed a challenge. Brad was thinking of a log home; Daryl wasn't so sure. The first step in this direction involved attending a log home show where a multitude of companies were exhibiting their products. The show opened their eyes to the wide variety of log homes on the market. Initially, one of the big questions would be whether to use round logs or flat logs, full logs or log siding. Then came the question of the type of wood, kiln-dried white pine or cedar. One of the easier decisions was to choose a post-and-beam interior. Daryl chuckles at the memory, "At a log home show you have all of the different options in front of you, so much information, and it's easy to become overwhelmed. What really helped us was actually visiting some log homes, and talking to the owners."

One home in particular, built by Coventry Log Homes of Woodsville, New Hampshire, sold them on the company. "Brad and I walked in," Daryl says, "and it was beautiful, spacious, with lots of windows, and lots of light, which was a priority for me. Light matters! We could see ourselves living in a home like this, which was completely different from what my notion of a 'log cabin' was."

Planning for the Thompson's 4,200-square-foot "Bear Rock Lodge," named after a rock formation that can be seen on the hillside, began in the

spring of 2008. "This home was patterned after the Coventry home Brad and I had visited in Woodsville," explains Daryl, "with many modifications." The Thompsons decided to expand the plan to include five bedrooms and five bathrooms. "We wanted our guests to have privacy," says Daryl. The couple also added height to the original plan. "The basement has 10-foot-high concrete walls," says Brad. "We also added another row of logs on the first-floor level, and four extra rows of logs on the second-floor level, increasing the ceiling height, making the rooms seem much more spacious. Eight-foot-high windows, instead of the typical six footers, further increase the sense of spaciousness, as well as increasing the amount of natural light in the home."

The Thompsons, particularly Brad, were onsite during most of the project. Brad's experience in the construction industry enabled him to lend a hand in the building. "Paul Martel, our builder," says Brad, "tried to keep me away from the tools, but otherwise included me in the process, and it resulted in both cost and time savings."

Coventry's log package was delivered in June of 2008, and the home was ready to inhabit by Christmas Eve, a mere six months later. "We had a hard-working crew," says Brad. "The house was basically built by two men, both of them energetic and trustworthy with great work ethics."

The fireplace stone came off the land and Brad hand-picked every single rock. "There were many huge piles of granite stones that had been cleared from the land on a skid plate pulled by horses, by the farmers a few generations before. These stones had been tossed over the edge of the field down into a creek bed." Brad used big wooden pallets to make box-shaped crates,

ABOVE: THE RIDGE BEAM OF THE HOME IS 24 FEET HIGH WITH A COMPLICATED TRUSS SYSTEM SUPPORTING THE VAULTED GREAT ROOM CEILING. BOLTED PLATES WERE ADDED TO THE TRUSS CONNECTIONS AND PAINTED IN AN ACCENT COLOR TO MATCH THE DINING ROOM CHAIRS AND HUTCH. THE THOMPSONS' FARMHOUSE DINING TABLE IS THE CENTERPIECE OF THE OPEN GREAT ROOM AND PROVIDES SEATING FOR AS MANY AS 12 GUESTS.

OPPOSITE TOP: KITCHEN CABINETS WERE PAINTED A SOFT SAGE GREEN TO COMPLEMENT THE WARM TONES OF THE WOOD. A LAUZON ENGINEERED WOOD FLOOR IN HICKORY IS A GREAT FEATURE IN THE HARD-WORKING KITCHEN. STAINLESS STEEL APPLIANCES INCLUDE A DOUBLE-DOOR JENN AIR REFRIGERATOR, VIKING STOVETOP RANGE AND OVENS, AND DOUBLE-DRAWER DISHWASHER. DARYL ALSO HAS A STANDARD DISHWASHER IN THE PANTRY FOR CLEANING UP AFTER LARGE GATHERINGS.

OPPOSITE INSET: A PANTRY SITUATED ADJACENT TO THE FRONT ENTRY AND KITCHEN AREAS IS EQUIPPED WITH A SINK AND DISHWASHER, PROVIDING THE THOMPSONS WITH AN ADDITIONAL PREP AND CLEAN-UP AREA.

then picked the rocks from his "quarry." Each stone had to have one flat face and be no more than five inches thick. He was able to haul 30 to 50 rocks on each crate, which weighed 1 to 1.5 tons. The full pallets of rock were hauled back to the house by a Lull, which Brad had purchased for the project.

"Oh, I have a few building stories to tell," says Brad, "including catching my wedding band on the seam of the metal roof when I was climbing up to seal



a leak that was coming in through the chimney. I slipped and fell and I was hanging from the seamless steel roof, saved by my wedding ring. My finger was split open and required stitches, and the ring was badly mangled, but it saved me." He ends that story with, "Daryl had it repaired and gave it to me as a Christmas gift."

With the help of his draftsman, Brad was able to adjust the structure to fit his and Daryl's exact needs. "We were able to tweak the floorplan to get it just right." He also consulted with his structural engineer, who advised beefing up the structure with well-placed steel beams. Brad explains, "We opted to eliminate six vertical posts on the lower level, as well as posts on the first floor, giving us uninterrupted space in the great room area."

Electrical layouts can be tricky in a log home. Once the Thompsons had their floorplan figured out, Daryl set about purchasing furnishings for the home because their placement would dictate the electrical layout on the exterior walls.

Daryl had help from a local interior designer, Deb Breault of GSI Designs, Inc. "Deb got involved a couple of months into the project. The house was up and the roof was going on, and our builder was ready to do the interior partitions. I was really stuck on whether or not to have closets in each of the bedrooms. I found Deb's name in a local business directory. I called her and she offered to come take a look at the house, at no charge. "The rest is history," says Daryl. "She was amazing, and won me over immediately. She



assured us that we definitely needed closets, explaining that weekend guests come loaded with gear!" Deb suggested some modifications to the floorplan that took advantage of unusable space in order to create closets and storage areas. "From that day on," says Daryl, "she became my eyes on the job site. There were always decisions to be made, and often I was three hours away. Deb was right near the house, so if there were any questions, from the electricians, plumbers, painters, even our builder, Paul, she would call me or make the executive decision herself. I had total confidence in her ability. And she was quick to speak up if she thought something needed changing."

The open great room is equally divided with ample comfortable seating near the fireplace, a long farmhouse table in the center of the room, and a well-designed, hardworking kitchen. Cabinets were custom made by Kitchen Encounters, Inc., of Laconia, New Hampshire.

The furnishings in the home are a mix of new traditional pieces and interesting New England antiques. Each room, including the laundry room, powder room, and pantry, is in keeping with a farmhouse feeling. "I love all things old, with character," says Daryl, who has created a sense of timelessness in the interiors of her home.

The Thompsons opted for radiant floor heat throughout the home. "It doesn't matter how cold the temperature is outside," Brad says, "you don't even think about it. The indoor temperature stays stable and comfortable. In addition, we have found radiant heat to be very economical, including the heat for the barn."

At the start of the project, Brad and Daryl were committed to following NH Electric Cooperative's Energy Star® guidelines for optimal energy savings. Their home ultimately received a five-plus star rating, the highest rating given. Qualifications included purchasing all Energy Star® appliances, sheetrock the garage and insulating all garage walls, using 400 series Andersen win-

DESIGN TIP

DARYL THOMPSON SAYS OF HER INTERIOR DESIGNER, "DEB'S BASIC DESIGN PHILOSOPHY IS THAT WHEN YOU WALK INTO A ROOM, IT SHOULD MAKE YOU SMILE!"

dows and Energy Star® approved doors, and installing two inches of rigid styrofoam insulation on the outside of the foundation and under the slab. The home also has five inches of sprayed-in foam insulation on the roof and around the dormers, as well as sprayed-in insulation at the boxed-sill and walkout basement framed walls. There is a complete envelope of insulation on the house, including the roof and floors, with an R-factor of 40.

The house proved to be so tightly insulated that an intake fan had to be installed into the base of the fireplace to provide ample oxygen for the fireplace. Mark Elliott, from Coventry Log Homes, says, "Working with the Thompsons provided a perfect

opportunity to showcase how energy efficient a log home can be when properly designed and constructed, using the best materials and building practices." White pine is the wood that Coventry offers their clients. It is harvested locally, kiln-dried, and is a major part of northern New Hampshire's natural resource economy.

From day one the Thompson home has been a gathering place for family and friends. Family members gathered for the holidays on that first Christmas and have been coming back ever since. There are four seasons of recreational opportunities in the Great North Woods, including golf, fishing and hunting, hiking, biking, 4-wheeling, snowmobiling, snowshoeing, downhill and cross-country skiing. "Our friends enjoy the winter activities," says Daryl.

BELOW: A SMALL ANTEROOM ADJACENT TO AN UPSTAIRS GUEST ROOM WAS DESIGNED AS A NURSERY AND PLAY AREA FOR THE THOMPSONS' GRANDCHILDREN.

OPPOSITE TOP: THE BLACK FOUR-POSTER, FRENCH SETTEE, AND TOILE FABRIC OF ONE OF THE GUEST ROOMS CONTRAST BEAUTIFULLY WITH THE LIGHT WALLS. A FAUX FIREPLACE WITH AN ANTIQUE MANTLE SUPPLIES THE AMBIENCE.

OPPOSITE BOTTOM: AMPLE LIGHT SPILLS INTO AN UPPER LEVEL GUEST BEDROOM, WITH BATHROOM TO THE RIGHT. DARYL CHOSE SHADES OF BROWN AND BLUE FOR THE ROOM, AND A QUILTED VELVET DUVET COVER FOR THE BED.



RIGHT: CUSTOM-MADE CABINETS AND SHELVING HOLD DARYL'S INVENTORY OF ARTS AND CRAFTS SUPPLIES, AS WELL AS HER RESOURCE BOOKS AND MAGAZINES. SHE USES THIS SPACE FOR WINDING DOWN AND VISITING WITH FRIENDS. A PANTRY/KITCHEN AREA FOR SNACKS AND BEVERAGES, AS WELL AS A BATHROOM AND LARGE STORAGE CLOSET ARE ADJACENT TO THE MAIN STUDIO ROOM, WHICH IS APPROXIMATELY 25 BY 25 FEET.

BELOW: THE BAR AND DEN AREA ARE LOCATED IN THE BASEMENT LEVEL OF THE THOMPSON HOME. THE FOOTPRINT OF THE BASEMENT LEVEL IS 30 BY 50 FEET, JUST LIKE THE MAIN FLOOR ABOVE. THE LAYOUT OF THE ROOMS, AND THE PARTITIONING, WAS DECIDED ON AFTER CONSTRUCTION WAS UNDERWAY. A BEDROOM BEYOND THE BAR HAS TWO SETS OF TWIN BUNKS DECORATED IN A NORTHWOODS THEME.



New Traditional

The Thompsons loved the Coventry log home they visited and decided to use it as the starting point for their own home. They increased the number of bedrooms and bathrooms to five each and added extra courses of logs on the first and second floors to increase the ceiling height. It may look like a traditional log home, but it has all the latest and best energy-saving products and building materials.



Log Home Producer: Coventry Log Homes,
Woodsville, New Hampshire
Log Home Builder: Paul Martel, Colebrook, New Hampshire
Interior Designer: Deb Breault, GSI Designs, Colebrook,
New Hampshire

Three-story home 🌟 Square Footage: 4,274
Bedrooms: 5 Baths: 5

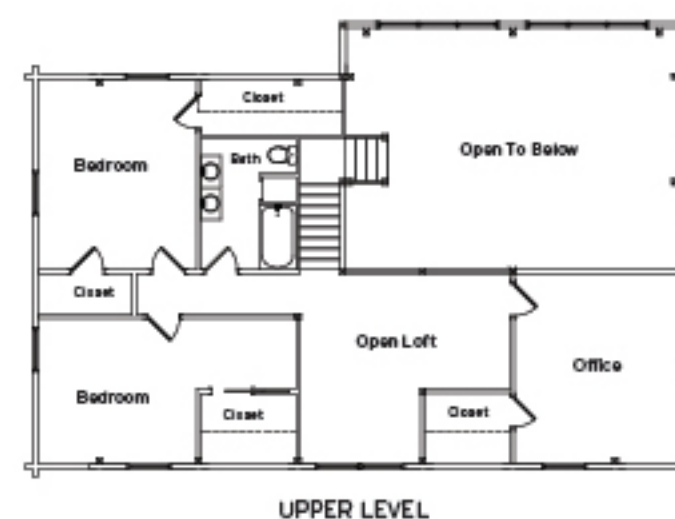

THE THOMPSONS' FLOORPLAN WAS A MODIFIED VERSION OF ONE OF COVENTRY'S CUSTOM-DESIGNED HOMES. BEDROOMS AND BATHROOMS WERE SITUATED TO OPTIMIZE PRIVACY FOR VISITING GUESTS.

A ROOMY SCREENED-IN PORCH AND OPEN DECKS ON THREE SIDES OF THE MAIN LEVEL CAPITALIZE ON VIEWS OF THE FARM AND PRISTINE SURROUNDING COUNTRYSIDE.

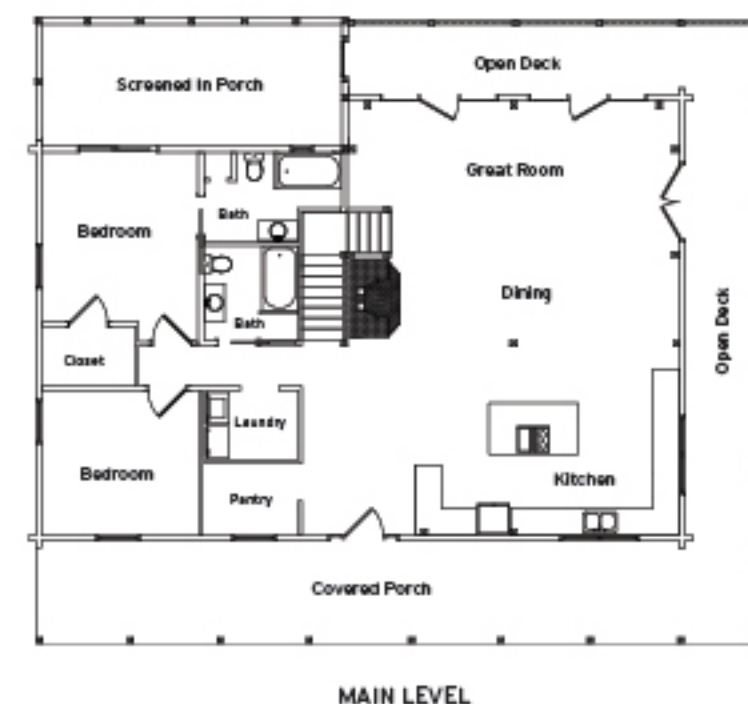

Relaxation time might be spent cozied up on the overstuffed leather furnishings in front of the great room fireplace, or heading to the barn, where Daryl's art studio is overflowing with an inventory of craft supplies, encouraging friends to explore their creativity.

Daryl thoroughly enjoys the intimate time in the studio with her friends and is envisioning broadening its use to include retreats and workshops that would offer a variety of artistic classes in such things as paper-crafting, fiber-arts, and photography, as well as cooking classes offered by guest instructors.

The Thompsons roughly divide their time between the relatively remote Bear Rock Lodge and their home in Gilford. They describe the personality of the Great North Woods communities of Stewartstown and Colebrook as friendly, open, and completely unpretentious. Colebrook's downtown is fun to shop, surprising visitors with its very own French bakery, some unique gift shops, and a hardware store that's more like an old-fashioned general store. There are also many restaurants, offering good food at reasonable prices.

The Thompsons describe their northern and southern New Hampshire lifestyles as drastically different, but equally fulfilling and rewarding. "We enjoy being involved in both communities," says Daryl. "Although Brad could be considered being close to retirement, his enthusiasm and passion for his business, as well as the numerous community activities he is involved in, keep him going at a pretty fast clip." "I hunt, fish, and play golf," says Brad. "When I'm up north mowing, tending the garden, and maintaining the farm, it's something like a meditation for me."

Indeed the Thompsons are great stewards of their land, utilizing all of the seasons to the fullest extent with fruit, vegetable, and flower gardening and year-round outdoor recreational activities. But most important to the couple is the gathering together of family and friends for plain old fun, relaxation and rejuvenation. 🌟

AN INDIANA COUPLE BUILDS A SECOND,
GRANDER VERSION OF THEIR TENNESSEE VACATION HOME.

Perfect Do-Over

BY KAREN DOSS BOWMAN ✦ PHOTOGRAPHY BY ROGER WADE STUDIO



FOR PETE AND TRISH DESOCIO, the second time's a charm. Within two years of building their dream vacation log home in Henry, Tennessee, the DeSocios had sold it and moved into an expanded version of the same house in nearby Paris.

The DeSocios, whose primary home is in Newburgh, Indiana, weren't looking to relocate their vacation spot. But when a realtor contacted the couple to see if they'd be interested in looking at the substantially larger Paris property, they decided to check it out. Drawn to the stunning beauty of the sprawling 350-acre property, which features a 155-acre lake, the couple considered this an opportunity to improve on a home they already considered flawless.

"Basically, the first house was so perfect, we thought, that when we built this second house, we just made it larger and on a grander scale," Pete says. "But we didn't buy the property until we knew we could build" next to the lake.

"We had a chance to work on things we thought we'd missed on our first house, and do it exactly the way we wanted on the second one," adds Trish. "Most people don't have that opportunity, so it worked to our advantage."



THE DESOCIO'S SPACIOUS GREAT ROOM OFFERS A QUIET SPOT FOR RELAXING AND PLENTY OF WALL SPACE WHERE PETE, AN AVID ARCHER, CAN DISPLAY HIS TROPHY MOUNTS. THIS VANTAGE POINT SHOWCASES THE HOME'S MOST RUSTIC, TRADITIONAL QUALITIES, INCLUDING HAND-Hewn SQUARE LOGS WITH CHINKING, WROUGHT-IRON JOINERY, AND THE HEAVY TIMBERED ROOF SYSTEM WITH DOUGLAS FIR SUPPORT BEAMS. THE LOFT RAILINGS WERE HANDCRAFTED OUT OF WHITE CEDAR.



THE DESOCIOS' WRAPAROUND PORCH FEATURES A COVERED SITTING AREA WITH A WOOD-BURNING FIREPLACE CONSTRUCTED OUT OF MULTICOLORED CULTURED STONES. THE HOMEOWNERS AND THEIR GUESTS ENJOY COOL EVENINGS BY THE FIRE WITH A STUNNING VIEW OF THE 155-ACRE LAKE.

Produced by Honest Abe Log Homes and built by Larry Bell of Volunteer Log Homes in Henry, Tennessee, the DeSocio home is constructed of 6x10-inch, square-profile Eastern white pine logs—known as Honest Abe's Original Chinked log. The building system includes chinking between the courses and dovetail corners. Additionally, the logs are hand-hewn on the outside as well as on the interior to add to the home's authentic, historical look.

"We've seen a resurgence in the past few years of people wanting this more traditional look with the chinking and the dovetail corners," says Josh Beasley, director of marketing and advertising at Honest Abe. "It's an Appalachian style—if you go into the woods here in Tennessee, the 150-year old cabins you'll see will look similar."

The Eastern white pine, a fast growing and sustainable species, is durable and an environmentally sound choice. The Honest Abe practice of air- and kiln-drying the wood results in tighter joints and stable logs that minimize future movement, shrinking, and settling.

The heavy timber roof system is constructed of 4x8-inch Douglas fir beams and 2x6-inch tongue-and-groove wood. Vaulted ceilings throughout the home showcase the exposed timbers. Adding to the home's thermal mass, explains Bell, are five inches of rigid foam insulation at the top of the roof, an air space for venting, decking, and a metal roof.

"The house is super sealed up, so there's no air leakage and no water leakage," says Bell, an Honest Abe dealer. "The energy efficiency is out of this world."

Even though the DeSocios were using the same basic floorplan from their first log home, expanding the new house did present some design chal-



THE BONUS ROOM OVER THE GARAGE DOUBLES AS THE "ULTIMATE MAN CAVE" AND A PRIVATE SPACE WHERE GUESTS CAN STAY WITH THEIR FAMILIES. THE AREA'S RUSTIC ELEMENTS—EXPOSED ROOF BEAMS, EASTERN WHITE PINE FLOORS, AND A BAR CONSTRUCTED OUT OF MULTICOLORED CULTURED STONE AND BLACK CERAMIC TILE COUNTERTOP—COMPLEMENT THE DESOCIOS' HOUSE.



GREEN TIP

CHOOSING A SUSTAINABLE LOG SPECIES THAT GROWS EASILY, SUCH AS EASTERN WHITE PINE, IS AN ENVIRONMENTALLY CONSCIOUS CHOICE THAT OFFERS OTHER BENEFITS. AS ONE OF THE HIGHEST THERMAL MASS VALUES OF ALL WOOD SPECIES, IT ALSO IS DURABLE AND LESS PRONE TO WARPING AND CHECKING.

THE HOME'S FOUNDATION IS COVERED WITH THE SAME CULTURED STONE USED TO MAKE THE INDOOR AND OUTDOOR FIREPLACES. THE DESOCIOS CHOSE MULTICOLORED STONES TO ADD POPS OF COLOR AGAINST THE BACKDROP OF THE WOOD TONES. THE THREE-TIERED ENTRANCE FEATURES IRON GATES THAT KEEP THE COUPLE'S DOGS FROM WANDERING OFF THE PORCH.

DESIGN TIP

A LAKESIDE HOME TYPICALLY NEEDS TO HAVE TWO FRONTS THAT ARE EQUALLY APPEALING. CAREFULLY DESIGN BOTH SIDES TO INCORPORATE THE VIEWS AND OFFER WELCOMING ENTRIES.



lenges. For example, the couple decided they wanted a garage on the new house. Not wanting to sacrifice a wall or the porch that completely wraps around the home, they worked with Bell to come up with an elaborate staircase that connects the detached garage to the house.

The bonus room above the garage serves as either the ultimate man cave or a secluded place for guests—particularly those visiting with families. In addition to a small kitchenette equipped with a small refrigerator, ice maker, sink, and bar, the space includes a full bathroom with Jacuzzi tub, a television, a gas log fireplace, and a pool table.

The new property's lake also added a design problem. The house essentially needed "two fronts," Peter says—one that would look fabulous from the lakeside and another that would create a grand entrance. Their solution was to design the lake side with an expansive wall of windows on each side of a massive fireplace running all the way up through the roof. The main entryway, located on the back side of the house, is inviting with a gable that features exposed timbers over a three-level porch accented by lampposts.

"We wanted the house to be elegant and rustic at the same time," Trish says.

The DeSocios' one-and-a-half story home makes efficient use of space through seemingly simple solutions. A spiral staircase, for example, is situated to one side of the great room, offering easy access to the loft without

ABOVE: THE MASTER BEDROOM HAS PLENTY OF LARGE WINDOWS FROM WHICH THE DESOCIOS CAN VIEW THE SUNRISE EACH MORNING. THE LOW-E WINDOWS IN THIS ROOM, AS WELL AS THROUGHOUT THE REST OF THE HOUSE, ADD TO THE HOME'S ENERGY EFFICIENCY AND CREATE A COMFORTABLE ATMOSPHERE FOR THE HOMEOWNERS AND THEIR GUESTS.

OPPOSITE TOP LEFT: A BUNK ROOM ON THE MAIN LEVEL OF THE HOME FEATURES FOUR SLEEPING SPACES FOR VISITORS. THE WOODEN BUNKS WERE BUILT BY ROCKY TOP LOG FURNITURE AND RAILING IN LANCASTER, KENTUCKY. THE DESOCIOS' BUILDER, LARRY BELL, REDESIGNED AND REBUILT THE LADDERS AND RAILINGS TO BE MORE FUNCTIONAL.

OPPOSITE TOP RIGHT: THE MASTER BATHROOM FEATURES A DOUBLE JACUZZI ENCASED IN A BEAUTIFUL WOOD FRAME DESIGNED BY BUILDER LARRY BELL. THE EARTH TONES OF THE CERAMIC FLOOR TILES COMPLEMENT THE SPACE AND ADD A TOUCH OF COLOR THAT BLENDS NICELY WITH THE WARM WOOD TONES.

OPPOSITE BOTTOM: THE GUEST BEDROOM OFFERS BREATHTAKING VIEWS OF THE LAKE AND THE SUNRISE EACH MORNING. THE DESOCIOS WERE ABLE TO DECORATE THIS ROOM WITH FURNITURE AND ACCESSORIES EACH HAD COLLECTED THROUGHOUT THEIR LIVES. "WE JUST PUT THESE THINGS IN THERE, AND IT CAME TOGETHER," TRISH SAYS.

BUILDING TIP

INSTALLING A SPIRAL STAIRCASE TO ACCESS THE LOFT IS A GREAT WAY TO SAVE SPACE WHILE ADDING A TOUCH OF CHARACTER TO THE HOME.



ABOVE: THE HOME'S FRONT ENTRANCE LEADS DIRECTLY INTO THE DINING ROOM, WHICH IS OPEN TO THE KITCHEN AND GREAT ROOM. THE FRONT DOOR CAME FROM A LOCAL SHOP, BUT BUILDER LARRY BELL DESIGNED AND CONSTRUCTED THE TRANSOM WINDOW AND SIDE-LIGHTS ABOVE THE DOOR. THE DESOCIOS INSTALLED A RETRACTABLE SCREEN DOOR ON THE EXTERIOR SIDE TO MAINTAIN AN UNOBSTRUCTED VIEW OF THE BEAUTIFUL WOODEN DOORS WHILE OFFERING THE OPTION OF LETTING IN FRESH BREEZES ON WARM SUMMER DAYS.

TOP: THE KITCHEN IS SEPARATED FROM THE GREAT ROOM AND DINING ROOM BY A BAR BUILT OUT OF THE SAME MULTICOLORED CULTURED STONES USED FOR THE FIREPLACES AND FOUNDATION ACCENTS. THE MARBLE COUNTERTOP IN A "RAINFOREST" COLOR, WHICH RESEMBLES CAMOUFLAGE, OFFERS A STRIKING CONTRAST WITH THE HICKORY CABINETRY.

taking up the space that a traditional staircase would occupy. It's also a beautiful conversation piece, made out of solid oak and without a center post. Another space-saving feature, says Trish, is that "there are no long, wasted hallways." The bedrooms are connected to the great room and dining room areas, with separate doors that can be closed off for privacy. Additionally, the couple asked Bell to build queen-sized beds into the slope of the roof in the loft.

Because the house was designed as a vacation home, outdoor spaces were an important consideration. The entire house is surrounded by a 10-foot-wide wraparound porch—an enlargement over the previous home's eight-foot-wide porch. One section of the porch contains a sitting area overlooking the lake and features a wood-burning fireplace. It's a great spot for relaxing and watching the many wild animals on the property, including wild turkey, deer, and a pair of eagles who nest nearby.

"What makes the wraparound porch so wonderful is that any time of the day you've got a place to sit where the temperature is ideal," Trish says. "There may be a welcome breeze on one side, or sunshine on another side. So the wraparound was ideal for spending time outdoors."

The home also includes outdoor spaces for the couple's two dogs—one of whom weighs just over three pounds and needs special protection from predators like hawks, which also occupy the property. The couple worked with Bell to come up with a design to make the gable end of the porch a three-level spot that's closed off with gates. This allows the dogs to roam around the spacious porches while keeping them at a safe distance from wild animals. Additionally, the couple built a dog run next to the garage to give the dogs a private space to roam freely.

The couple has no plans for a third log home, feeling content that they've got the best location and design they could have imagined. For prospective log home owners, Pete suggests: "Build a log home if you want one—you'll wish you'd done it a long time ago.... There's nothing like the magic of a log home." 🌲



Log Home Producer: Honest Abe Log Homes, Moss, Tennessee
Log Home Builder: Larry Bell, Volunteer Log Homes, Henry, Tennessee
Square Footage: 2,859 (main house); 815 (garage bonus room)
1.5 story home 🌲 Bedrooms: 3 Baths: 3

Second Time Around

It was the spectacular 355-acre property with its 155-acre lake that enticed the DeSocios to sell their first vacation log home and build a new one. Using the same floorplan, they expanded the new home, adding a garage and more outdoor living spaces. With its wraparound porch, it is stunning from all sides.

ALL THREE BEDROOMS ON THE MAIN LEVEL OF THE HOUSE HAVE ACCESS TO THE WRAPAROUND PORCH, GIVING VISITORS THE PRIVACY TO COME AND GO AS NEEDED WITHOUT DISTURBING OTHERS STAYING IN THE HOME.

BY ELIMINATING HALLWAYS AND MAKING BEDROOMS ON THE MAIN FLOOR ACCESSIBLE FROM THE GREAT ROOM AREA, THE DESOCIOS CREATED A COMPACT FLOOR DESIGN THAT MAKES EFFICIENT USE OF SPACE.

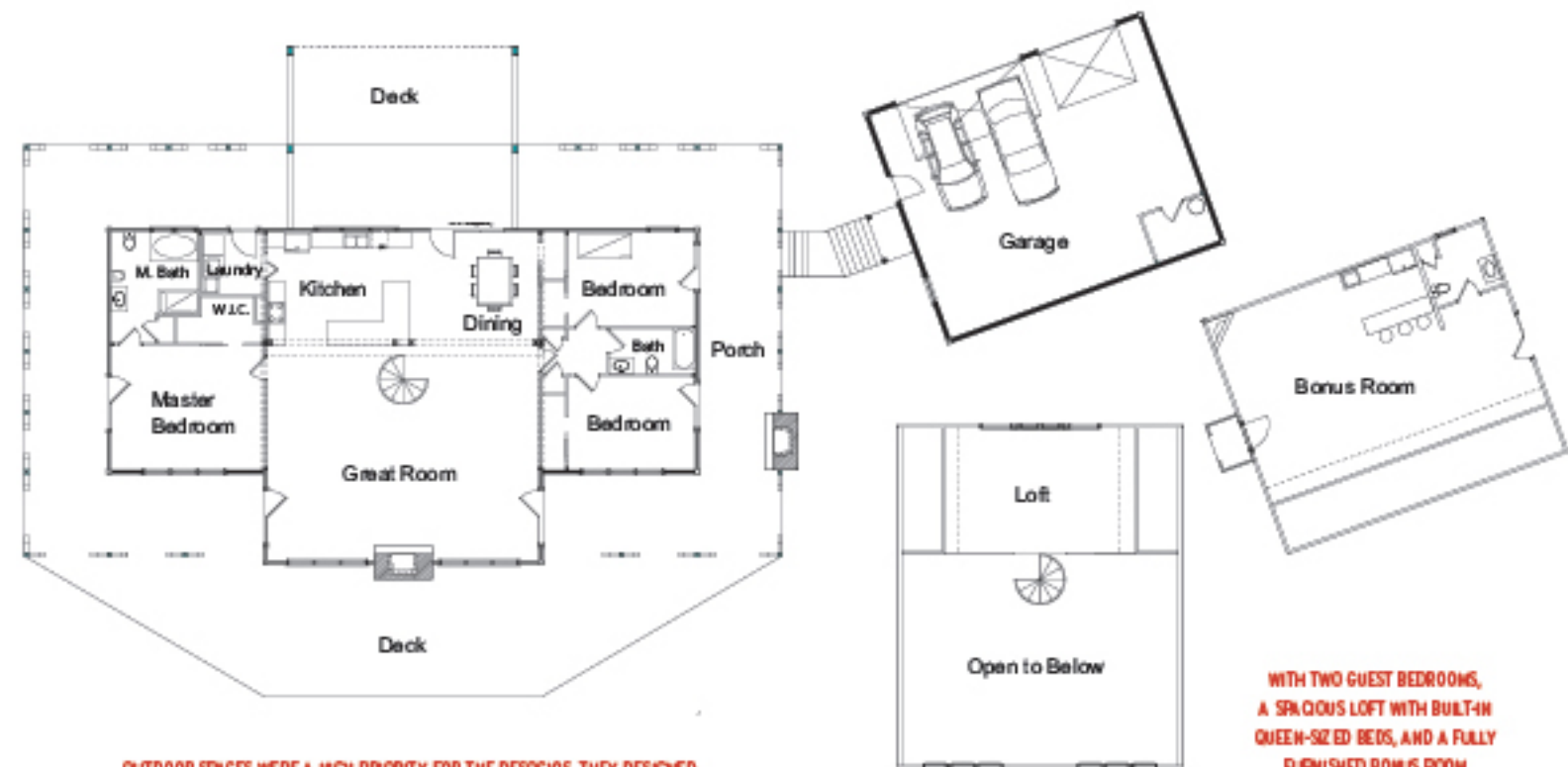

OUTDOOR SPACES WERE A HIGH PRIORITY FOR THE DESOCIOS. THEY DESIGNED THE HOME WITH A 10-FOOT-WIDE WRAPAROUND PORCH, SPACIOUS DECKS ON THE FRONT AND BACK SIDES OF THE HOUSE, AND AN OUTDOOR FIREPLACE.

THE GREAT ROOM, DINING ROOM, AND KITCHEN ARE SITUATED IN AN OPEN, CENTRAL AREA WITH THE MASTER BEDROOM ON ONE SIDE AND GUEST QUARTERS ON THE OTHER, OFFERING BOTH THE HOMEOWNERS AND THEIR VISITORS AN ADDED MEASURE OF PRIVACY.

WITH TWO GUEST BEDROOMS, A SPACIOUS LOFT WITH BUILT-IN QUEEN-SIZED BEDS, AND A FULLY FURNISHED BONUS ROOM ABOVE THE GARAGE, THE DESOCIOS HAVE 14 SLEEPING SPACES TO ACCOMMODATE GUESTS.